

**Attachments for Excavators 15 t - 60 t | Industrial Solutions**



# TEREX ATLAS attachments for every task

A construction machine will only work completely efficiently if the tools and add-on units are designed precisely for that machine and that area of use.

As an experienced manufacturer of construction machinery, TEREX ATLAS has developed a comprehensive range of add-on tools for hydraulic diggers, which significantly increase the productivity rate of any machine.

At the TEREX ATLAS machine factory, all parts are manufactured using the latest production techniques and according to the highest quality standards. Carefully selected materials and sophisticated technologies which have been planned in detail guarantee a long working life.

All TEREX ATLAS working equipment for hydraulic excavators corresponds to the EC machine directive and is marked with the CE label.

As all-round specialists in the rational, profitable operation of hydraulic excavators, TEREX ATLAS experts will be happy to advise you and, together with you, will be able to find the ideal solution to your problem.

## Quick release equipment

### II. Buckets

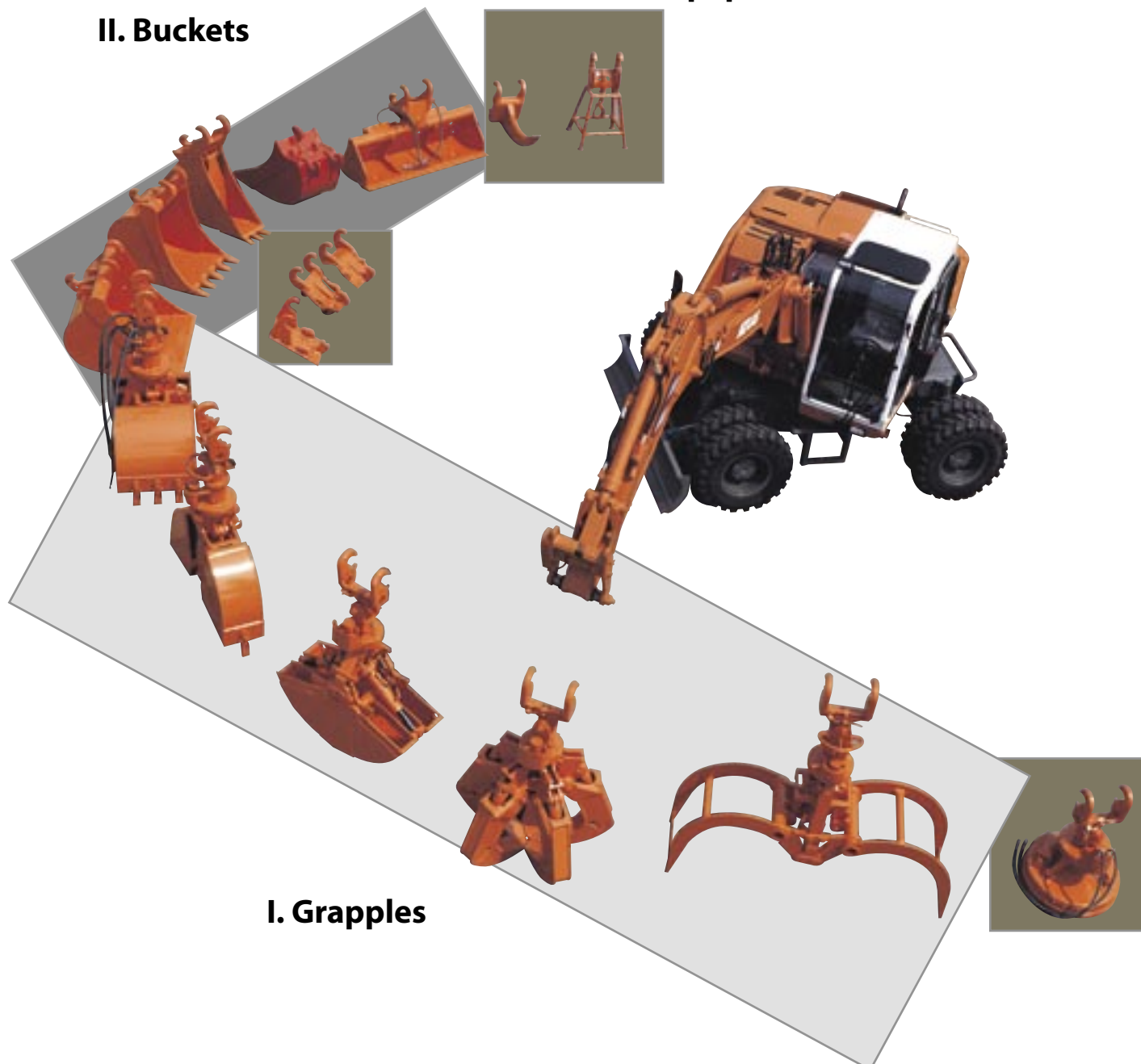

### I. Grapples

	Seite
<b>Summary of grapples listed by operating weight of excavator</b>	<b>4</b>
<b>Direct mounting and quick release equipment</b>	<b>5</b>
Quick release equipment TEREX ATLAS	6
Accessories for grapples with grab rotation device	7
Accessories for grapples with rotator	8
<b>Grapples</b>	
<b>Re-handling clamshell buckets</b>	
up to 40t operating weight      with horizontal cylinders: ZSG 40H	10
up to 60t operating weight      with horizontal cylinders: ZSG 60H	11
<b>Timber grapples</b>	
up to 18t operating weight      with vertical cylinders: HG 18V	12
up to 25t operating weight      with vertical cylinders: HG 25V	13
up to 35t operating weight      with vertical cylinders: E 724/2V	14
<b>Beet grapples</b>	
up to 25t operating weight      with horizontal cylinders: RUEG 25H	15
<b>Demolition and sorting grapples</b>	
up to 27t operating weight      with horizontal cylinders: SOR 15H/SOR 20H/SOR 27H with metal ribs	16
with horizontal cylinders: SOR 15H-P/SOR 20H-P/SOR 27H-P with perforated skin	17
<b>Orange peel grapples</b>	
up to 20t operating weight      with vertical cylinders: E 320 - E321	18
with vertical cylinders: MSG 20	19
up to 25t operating weight      with vertical cylinders: MSG 25	20
up to 35t operating weight      with vertical cylinders: E 650 - E 751	21
with vertical cylinders: MSG 35-600-5	22
with vertical cylinders: E 850 - E 861	23
with vertical cylinders: MSG 35-800-4/-5	24
with vertical cylinders: MSG 35-6	25
up to 50t operating weight      with vertical cylinders: MSG 50	26
USPs of the orange peel grapple type MSG	27

# Summary of grapples listed by operating weight of excavator

Type	recommended operating weight of excavator (t)																						
Re-handling clamshell bucket (= ZSG)																							
	15	16	17	18	19	20	21	22	23	24	25	26	27	...	30	...	35	...	40	...	50	...	60
ZSG 40H																							
ZSG 60H																							

Timber grapple (= HG)																								
	15	16	17	18	19	20	21	22	23	24	25	26	27	...	30	...	35	...	40	...	50	...	60	
HG 18V																								
HG 25V																								
E 724/2V																								

Demolition and sorting grapple (= SOR)																							
	15	16	17	18	19	20	21	22	23	24	25	26	27	...	30	...	35	...	40	...	50	...	60
SOR 15H																							
SOR 15H-P																							
SOR 20H																							
SOR 20H-P																							
SOR 27H																							
SOR 27H-P																							

Orange peel grapple (= MSG)																								
	15	16	17	18	19	20	21	22	23	24	25	26	27	...	30	...	35	...	40	...	50	...	60	
E 320 - E 321																								
MSG 20																								
MSG 25																								
E 650 - E 751																								
MSG 35																								
E 850 - E 861																								
MSG 50																								

Others																								
	15	16	17	18	19	20	21	22	23	24	25	26	27	...	30	...	35	...	40	...	50	...	60	
Beet grapple RUEG 25H																								

## Legend:



Grapples with horizontal cylinders (H = horizontal)



Grapples with vertical cylinders (V = vertical, Type E = with exchangeable shells)



Grapples with vertical cylinders and grab rotation device (Type E)





## Direct mounting and Quick release equipment (SWE)

The grapples and buckets can be mounted directly on the jib end of the excavator or they can be connected via an adapter of a quick release equipment. The quick release equipment (SWE) enables a rapid change from bucket to grapple or other attachments and load hooks.

TEREX ATLAS offers two different types of quick release equipments:

- Quick release equipment to change from grapple to grapple or to load hook (bucket tipping ram with linkage not necessary)
- Quick release equipment to change from bucket to bucket or to grapple or other attachments or load hook (bucket tipping ram with linkage necessary)

Alternatively to the TEREX ATLAS quick release equipment the quick change system of Lehnhoff or other manufacturers are available.

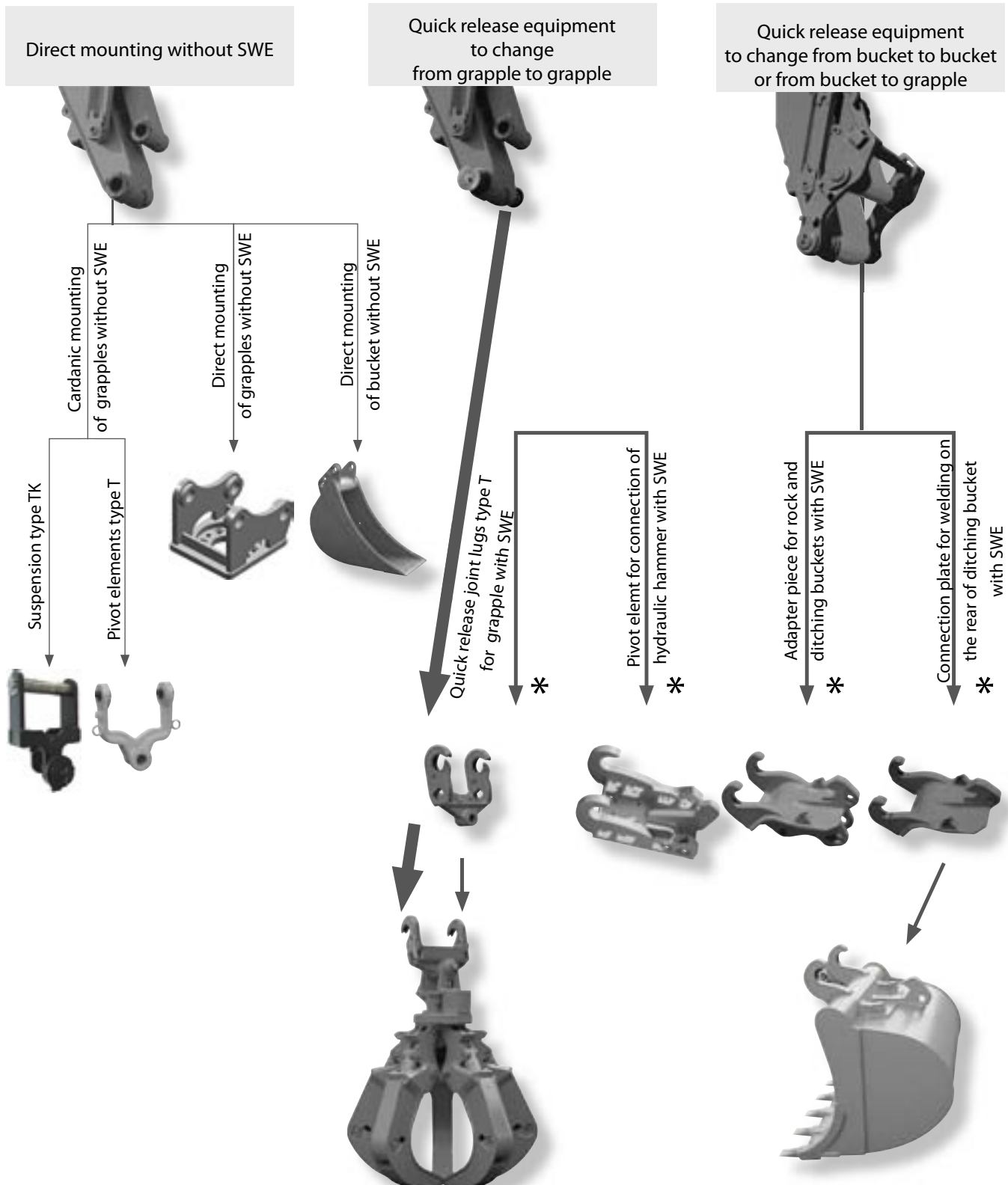

\* Alternatively the quick change system of Lehnhoff or other manufacturers are available

# Quick release equipment TEREX ATLAS

The quick release equipment (SWE) of TEREX ATLAS is specifically designed for grapples with grab rotation devices. The SWE is directly mounted onto the jib end of the excavator. The attachments must be equipped with an adapter fitting the the SWE:

- quick release joint lugs for the cardanic mounting of grapples
- adapter for rigid mounting of grapples, buckets and special tools

## Quick release equipment to change from grapple to grapple



Price (€)	Type	Product No.	Description	Jib end Width (mm)	Pin-Ø (mm)	Excavator type TEREX ATLAS
352.- T	T 610	1491130	pin with key	268 (closed)	60	1104 - 1605 (1604/1705)
404.- T	T 713	5411267	pin with key	345 (closed)	80	1704/1804

## Quick release joint lugs suitable for quick release system (SWE) TEREX ATLAS

The quick release joint lugs are used instead of pivot elements for cardanic mounted grapples with grab rotation device and enable a rapid change of attachments due to the quick release equipment TEREX ATLAS. The quick release joint lugs are specifically designed for grapples with grab rotation device. Grapples with rotator (type DW) can be adapted to the quick release joint lugs by using special head plates.

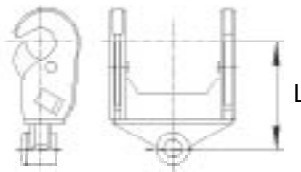

Price (€)	Grab rotation device		Product No.	Length L (mm)	Self weight (kg)	Connection for SWE TEREX ATLAS (Type)	Jib end: Width / Pin-Ø (mm)	Excavator type TEREX ATLAS
	E 2.62 E 732	E 832-2						
1060.- T	T 730		4578174	420	75	T 610	268 (closed) / 60	11 - 1605 (1604/1705)
1380.- T	T 734		3510876	455	90	T 713	345 (closed) / 80	1704/1804
1530.- T		T 832	4540738	600	126	T 713	345 (closed) / 80	1704/1804/5205

## Load hook - direct mounting and suitable for SWE TEREX ATLAS



Price (€)	Type	Product No.	Load capacity (kN)	Length L (mm)	Self weight (kg)	Connection for SWE TEREX ATLAS (Type)	for Jib end: Width / Pin-Ø (mm)	Excavator type TEREX ATLAS
1000.- T	K 610	1907393	150	690	50	-	268 (closed)/ 60	11-1504/1605 (1604/1705)
1520.- T	K 610SW	2225061	150	790	75	T 610		
1230.- T	K 713 *	4580429	210	650	55	-	345 (closed) / 80	1704/1804
1790.- T	K 713SW *	2225094	210	690	70	T 713		

\* not turnable

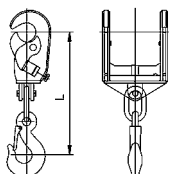
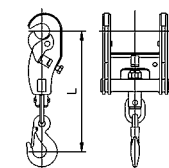

all taxes extra

# Accessories for grapples with grab rotation device

## Pivot elements (type T) for grapples with grab rotation device

The pivot elements are designed for grapples with grab rotation device. Grapples with rotator (type DW) can be adapted to the pivot elements by a special head plate.



pivot element  
for closed jib end

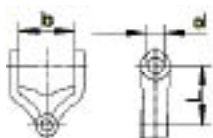

pivot element  
for forked jib end

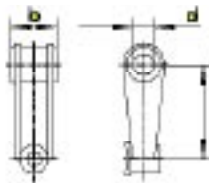

Grab rotation device		Product No.	b	d	L	Self weight	Jib end: Width / Pin-Ø	Excavator type TEREX ATLAS	Price (€)
E 2.62 E 732	E 832-2								
Pivot element			(mm)	(mm)	(mm)	(kg)	(mm)		
	T 64	<b>2228779</b>	270	60	450	63	268 (closed) / 60	14 - 1605 (1604/1705)	750.- T
	T 63.04	<b>4568490</b>	303	80	400	55	300 (closed) / 80	1604/1805/1905 1704/2005/2205	770.- T
	T 72	<b>1572898</b>	347	80	380	55	345 (closed) / 80	1704/1804	940.- T
		<b>3167460</b>	347	80	480	122	345 (closed) / 80	1804/5205	1200.- T

## Hose package for grapples with grab rotation device - hoses between grab rotation device and jib end



Grab rotation device		Product No.	Jib end: Width / Pin-Ø	Excavator type TEREX ATLAS	Price (€)
E 2.62 E 732	E 832-2				
Pivot element or Quick release joint lug			(mm)		
	T 64 / T 730 T 620-300	<b>5404031</b>	268 (closed) / 60	12 - 1605 (1604/1705) 1604 / 1805 / 1905	332.- T
	T 730 / T 64	<b>3178645</b>		1304K, 1605(1604), 1705 (industrial and telescopic jib)	340.- T
	T 64 / T 730	<b>6079002</b>		1604 MI	302.- T
	T 72 / T 734	<b>5412439</b>	345 (closed) / 80	1704 / 1804 (industrial and telescopic jib)	302.- T
	T 82 / T 832	<b>5412440</b>		1804 (industrial and telescopic jib)	350.- T
	T 832	<b>6041142</b>		5205	476.- T

**Package consists of:** 4 hoses between grab rotation device and jib end with standard couplings

# Accessories for grapples with rotator

## Upper suspension (type TK) for grapples with rotator for TEREX ATLAS excavators

The upper suspensions (type TK) are suitable for grapples with rotator. The upper suspension can be equipped with pendulum damper.

Price (€)		Rotator with upper connection (Width x Pin-Ø in mm)		b	d	L	Self weight (approx.)	Jib end: Width / Pin-Ø
		125x60	180x70					
		DW 10F275-60	DW 15F340-70 integriertes rotator					
		Product No.		(mm)	(mm)	(mm)	(kg)	(mm)
640.-		Upper suspension without pendulum damper TK 501	6088029	270	60	515	80	268 (closed) /60
1190.-			6088030	270	60	625	145	
640.-			6088031	303	80	515	80	300 (closed) /80
1190.-			6088032	303	80	625	145	
640.-			6088034	347	80	515	80	345 (closed) /80
1190.-			6088035	347	80	625	145	
640.-			6088036	208	80	420	50	210/450 forked/ 80
1190.-			6088037	208	80	435	65	
1300.-		Upper suspension with pendulum damper TK 511	6088048	270	60	515	80	268 (closed) /60
2125.-			6088049	270	60	625	145	
1300.-			6088050	303	80	515	80	300 (closed) /80
2125.-			6088051	303	80	625	145	
1300.-			6078537	347	80	515	80	345 (closed) /80
2125.-			6078574	347	80	625	145	
1300.-			6088052	208	80	420	50	210/450 forked/ 80
2125.-			6088053	208	80	435	65	

## Upper suspension (type TK) for grapples with rotator for other excavators

The upper suspensions can be used for other excavators. Please specify the type of excavator when ordering.

### TK 501 – Upper suspension without pendulum damper for other excavators

Price (€)		Type	Rotator of the grapple (Type)	Upper connection of rotator (Width x Pin-Ø in mm)
640.-		TK 501 - 125x60	DW 10F275-60	125x60
1190.-		TK 501 - 180x70	DW 15F340-70 / integrated rotator	180x70

### TK 511 – Upper suspension with pendulum damper for other excavators

Price (€)		Type	Rotator of the grapple (Type)	Upper connection of rotator (Width x Pin-Ø in mm)
1300.-		TK 511 - 125x60	DW 10F275-60	125x60
2125.-		TK 511 - 180x70	DW 15F340-70 / integrated rotator	180x70

all taxes  
extra



# Accessories for grapples with rotator

## Accessories for rigid mounting of grapples with rotator

### Adapter for rigid mounting



Type	Product No.	Operating weight excavator	Price (€)
AFest 15t	6085665	up to 15t	1295.-
AFest 20t	6085666	up to 20t	1315.-
AFest 27t	6085667	up to 27t	1810.-

### Adapter connection plate for specific solutions



Type	Product No.	Operating weight excavator	Price (€)
AD K15t	6085670	up to 15t	260.-
AD K20t	6085671	up to 20t	395.-
AD K27t	6085672	up to 27t	555.-

## Adapter for quick change system of Lehnhoff for grapples with rotator

### Adapter for cardanic mounted grapples without upper suspension

The adapter is delivered without suspension. Please specify type of excavator when ordering.



Type	Product No.	suitable for quick change system of Lehnhoff	Operating weight excavator	Price (€)
GA 10 MS10 19t	6085653	MS10	up to 19t	1600.-
GA 20 MS20 26t	6085654	MS20	up to 26t	2450.-
GA 21 MS21 28t	6085655	MS21	up to 28t	2585.-
GA 25 MS25 40t	6085656	MS25	up to 40t	2585.-
GA 40 HS40 70t	6085657	HS40	up to 70t	6300.-

**Please note:** Adapter of other manufacturers are available.

on request

### Adapter for rigid mounted grapples



Type	Product No.	suitable for quick change system of Lehnhoff	Operating weight excavator	Price (€)
SA 10 MS10 19t	6071057	MS10	up to 19t	1720.-
SA 20 MS20 26t	6085674	MS20	up to 26t	1945.-
SA 21 MS21 28t	6075689	MS21	up to 28t	2165.-

**Please note:** Adapter of other manufacturers are available.

on request

## Hose package for grapple with rotator - hoses between rotator and jib end

		Rotator * with upper connection (Width x Pin-Ø in mm)		Price (€)
		125x60	180x70	
		DW 10F275-60	DW 15F340-70 integrated rotator	
Excavator type TEREX ATLAS	Jib end: Width / Pin-Ø	Product No.		
	12 - 1605 (1604 / 1705) 1604 / 1805 / 1905 1304K 1605(1604) 1705 (industrial and telescopic jib)	268 (closed) / 60	<b>6087888</b>	330.-
	1604/1805/1905 1704/2005/2205	300 (closed) / 80	<b>6087890</b>	340.-
	1704/1804	210/450 forked/ 80	<b>6087892</b>	365.-
	1704 / 1804 (industrial and telescopic jib)	345 (closed) / 80	<b>6087893</b>	365.-
	5205		<b>6088832</b>	380.-
			<b>6088833</b>	475.-
			<b>6087894</b>	
			<b>6087895</b>	
			<b>6087896</b>	
			<b>6087897</b>	

\* the hoses fit to rotators with the standard head plate as well as to rotators with the optional head plate

**Package consists of:** 4 hoses between rotator and jib end with standard couplings

**all taxes extra**

## ZSG 40H

## Re-handling clamshell bucket

**Durable Re-handling Clamshell Bucket, especially for loading bulk materials for excavators from 25t to 40t operating weight.**

- maximum volume due to widely spaced pivots with a flat closing curve. Protection of the ground surface is guaranteed, e.g. discharge from boat and train carriages etc.
- precise positioning with an integrated rotator
- long life is ensured due to the use of 500 HB steel in the manufacture of cutting edges
- robust, fully integrated rotator that is fixed at 4 points to withstand external forces, with pressure relief valve to ensure overload protection, with connecting hoses located inside the hub
- integrated non-return valve guarantees security of the load
- excellent digging characteristics are the result of high closing forces (57 kN at an operating pressure of 35 MPa)



### Re-handling clamshell bucket ZSG 40H

Price (€)	Type	Product No.	Width B (mm)	Volume (litre)	Self weight (kg)	Load capacity (kg)	Torque (Nm)
19150.–	<b>ZSG 40H-1250</b>	<b>6086120</b>	1250	1540	1550	7000	3000
20495.–	<b>ZSG 40H-1500</b>	<b>6086131</b>	1500	1850	1650	7000	3000
21840.–	<b>ZSG 40H-1750</b>	<b>6086132</b>	1750	2150	1750	7000	3000
23185.–	<b>ZSG 40H-2000</b>	<b>6086133</b>	2000	2460	1850	7000	3000

#### Package consists of:

Re-handling clamshell bucket, integrated rotator with 4 fixing points (Pin-Ø 70/ Width 180 mm), non-return valve

### Accessories

-> further accessories see pages 6ff.

Price (€)	Type	Product No.	Description
1190.–	<b>TK 501 - 180x70</b>	<b>6088035</b>	upper suspension w/o pendulum damper for closed jib end (ATLAS) width 345 / Ø 80 mm & integrated rotator
2125.–	<b>TK 511 - 180x70</b>	<b>6078574</b>	upper suspension with pendulum damper for closed jib end (ATLAS) width 345 / Ø 80 mm & integrated rotator
2585.– on request	<b>GA25 MS25 40t</b>	<b>6085656</b>	adapter for quick change system Lehnhoff SW/MS25 without upper suspension – up to 40t adapter for quick change systems from other manufacturers available

### Requirements of excavator

#### Operating pressure:

#### Pump capacity:

#### Hydraulic connection (rotator/grapple)

max. 35 MPa (350 bar)

100 to 250 l/min

G 1 1/2" / SAE 3/4"

### Technical drawings

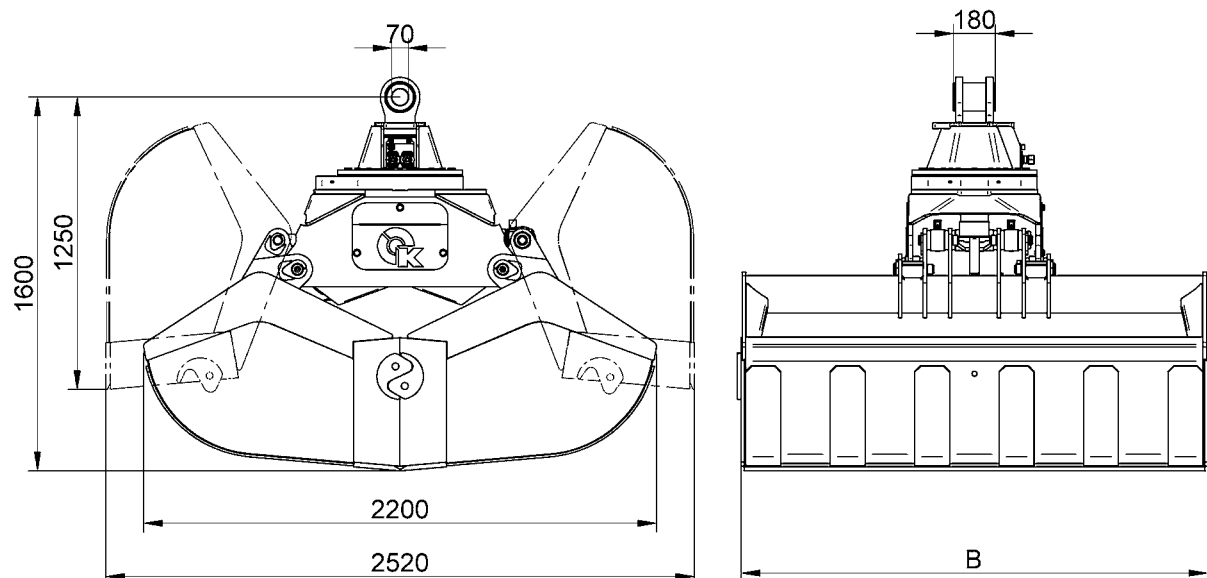

## Re-handling clamshell bucket

**ZSG 60H**

**Durable Re-handling Clamshell Bucket, especially for loading bulk materials for excavators from 40t to 60t operating weight.**

- larger gripping volume due to widely spaced pivots with a flat closing curve. Protection of the ground surface is guaranteed, e.g. discharge from boat and train carriages etc.
- Precise positioning with an integrated rotator
- long life is ensured due to the use of 500 HB steel in the manufacture of cutting edges
- robust, fully integrated rotator that is fixed at 4 points to withstand oncoming forces, with pressure relief valve to ensure overload protection, with connecting hoses located inside the hub
- integrated non-return valve guarantees security of the load
- excellent digging characteristics are the result of high closing forces (74 kN at an operating pressure of 35 MPa)



### Re-handling clamshell bucket ZSG 60H

Type	Product No.	Width B (mm)	Volume (litre)	Self weight (kg)	Load capacity (kg)	Torque (Nm)	Price (€)
<b>ZSG 60H-1250</b>	<b>6086134</b>	1250	1875	1700	9000	3000	23290.–
<b>ZSG 60H-1500</b>	<b>6086135</b>	1500	2250	1800	9000	3000	27740.–
<b>ZSG 60H-1750</b>	<b>6086136</b>	1750	2625	1900	9000	3000	31050.–
<b>ZSG 60H-2000</b>	<b>6086137</b>	2000	3000	2000	9000	3000	34675.–
<b>ZSG 60H-2750</b>	<b>6086138</b>	2750	4125	2300	9000	3000	37500.–

#### Package consists of:

Re-handling clamshell bucket, integrated rotator with 4 fixing points (Pin-Ø 70/ Width 180 mm), non-return valve

#### Accessories

-> further accessories see pages 6ff.

Type	Product No.	Description	Price (€)
<b>TK 501 - 180x70</b>	<b>6088035</b>	upper suspension w/o pendulum damper for closed jib end (ATLAS) width 345 / Ø 80 mm & integrated rotator	1190.–
<b>GA40 HS40</b>	<b>6085657</b>	adapter for quick change system Lehnhoff SW/HS40 without upper suspension – up to 70t	6300.–
		adapter for quick change systems from other manufacturers available	on request

#### Requirements of excavator

**Operating pressure:**

max. 35 MPa (350 bar)

**Pump capacity:**

100 to 250 l/min

**Hydraulic connection (rotator/grapple)**

G 1/2" / SAE 3/4"

#### Technical drawings

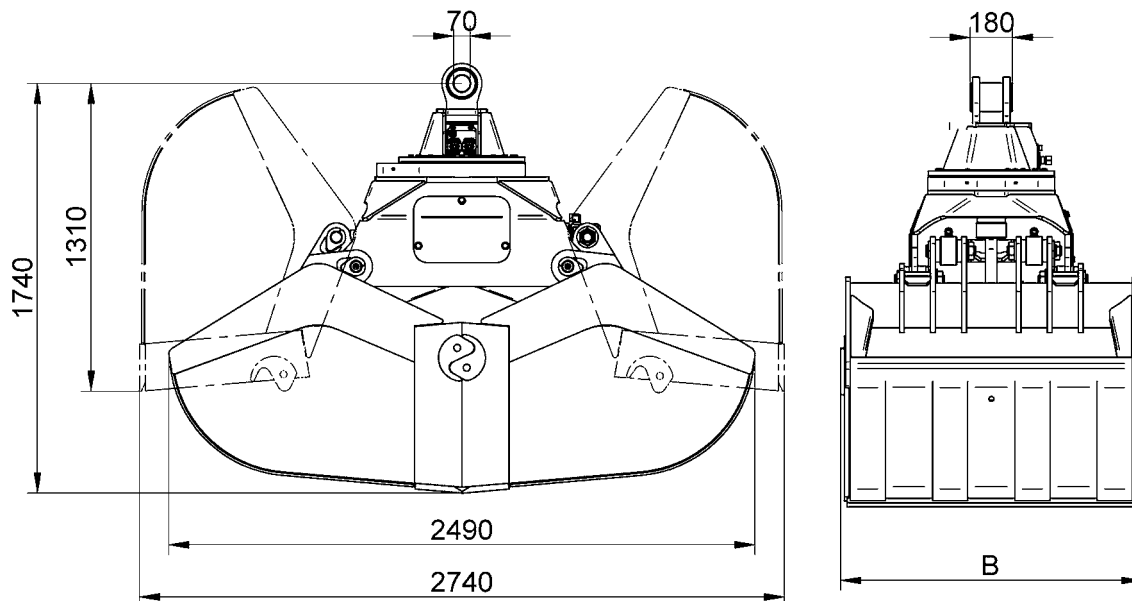

all taxes  
extra

## HG 18V

## Timber grapple

**Timber grapple for mobile excavators and static excavators from 13t up to 18t operating weight**

- long life is ensured due to the use of 500 HB steel in the manufacture of cutting edges
- reduced wear resulting from generously dimensioned bearing system
- rotator integrated in the gripping arm carrier
- excellent closing characteristics
- high closing forces (35 kN at a volume of 0,60m<sup>2</sup> and an operating pressure of 35 MPa)
- optional the grapple can be equipped with a special head plate fitting to pivot elements T63.04, T64, T71, T72 or quick release joint lugs T730, T63.64, T731, T734



### Timber grapple HG 18V

Price	Type	Product No.	Opening range A (mm)	Height C (mm)	Smallest trunk Ø (mm)	Volume (m <sup>2</sup> )	Self weight (kg)	Load capacity (kg)	Closing force (kN)
(€)									
6820.-	<b>HG 18V-0,60</b>	<b>6086143</b>	1990	2195	900	0,60	610	4500	35
7100.-	<b>HG 18V-0,80</b>	<b>6086144</b>	2180	2190	100	0,80	635	4500	32
7380.-	<b>HG 18V-1,00</b>	<b>6086145</b>	2350	2390	1100	1,00	660	4500	30
7660.-	<b>HG 18V-1,25</b>	<b>6086146</b>	2500	2480	1200	1,25	685	4500	28

**Package consists of:** Timber grapple, rotator, non-return valve and hose guard

### Rotator

Continuous rotation and two oil passages. Overload protection is ensured by pressure relief valves.

Price	Type	Product No.	Upper connection (WidthxPin-Ø) (mm)	Torque (Nm)	Moment of deflection (Nm)
(€)					
inkl.	<b>DW 10 F275-60</b> with standard head plate for TK-suspension		125 x 60	1500	14000
add 900.-	<b>optional</b> available with head plate (incl. pin) for pivot elements (T-series)	<b>6087926</b>	for pivot elements T31, T35, T36 or quick release joint lug T630	1500	14000

### Accessories

Price	Type	Product No.	Description	-> further accessories see pages 6ff.
(€)				
640.-	<b>TK 501- 125x60</b>	<b>6088029</b>	upper suspension w/o pendulum damper for closed jib end (ATLAS) width 268 / Ø 60 mm & DW 10F275-60	
1300.-	<b>TK 511 -125x60</b>	<b>6088048</b>	upper suspension with pendulum damper for closed jib end (ATLAS) width 268 / Ø 60 mm & DW 10F275-60	
1600.-	<b>GA 10 MS10 19t</b>	<b>6085653</b>	adapter for quick change system Lehnhoff SW/MS10 without upper suspension – up to 19t	
2450.-	<b>GA 20 MS20 26t</b>	<b>6085654</b>	adapter for quick change system Lehnhoff SW/MS20 without upper suspension – up to 26t	
on request			adapter for quick change systems from other manufacturers available	

### Requirements of excavator

**Operating pressure:** max. 35 MPa (350 bar)  
**Pump capacity:** 75 to 250 l/min

### Technical drawings

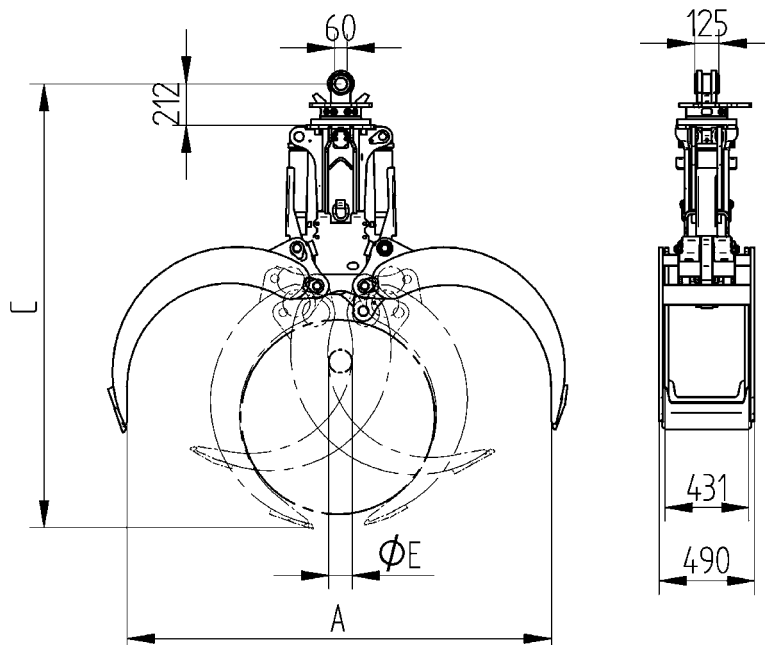

**optional:**  
special head plate fitting to  
pivot elements T31, T35, T36 or quick  
release joint lug T630

all taxes  
extra

# Timber grapple

## HG 25V

**Timber grapple for mobile excavators and static excavators up to 25t operating weight**

- long life is ensured due to the use of 500 HB steel in the manufacture of cutting edges
- reduced wear resulting from generously dimensioned bearing system
- rotator integrated in the gripping arm carrier
- excellent closing characteristics
- high closing forces (36 kN at a Volume of 1,5 m<sup>3</sup> and an operating pressure of 35 MPa)
- optional the grapple can be equipped with a special head plate fitting to pivot elements T63.04, T64, T71, T72 or quick release joint lugs T730, T63.64, T731, T734



### Timber grapple HG 25V

Type	Product No.	Opening range A (mm)	Height C + rotator (mm)	Smallest trunk Ø (mm)	Volume (m <sup>3</sup> )	Self weight (kg)	Load capacity (kg)	Closing force (kN)	Price (€)
HG 25V-0,80	6086147	2100	2090	100	0,80	1225	6000	45	10815.-
HG 25V-1,00	6086148	2250	2155	125	1,00	1235	6000	42	11085.-
HG 25V-1,25	6086149	2420	2245	150	1,25	1265	6000	40	11360.-
HG 25V-1,50	6086150	2780	2405	175	1,50	1340	6000	34	11685.-

**Package consists of:** Timber grapple, rotator, non-return valve, hose guard, 2 welded hooks

### Rotator

Continuous rotation and two oil passages. Overload protection is ensured by pressure relief valves.

Type	Product No.	Upper connection (Width x Pin-Ø) (mm)	Torque (Nm)	Moment of deflection (Nm)	Price (€)
DW 15 F340-70 with standard head plate for TK-suspension		180 x 70	3000	25000	incl.
optional available with head plate (incl. pin) for pivot elements (T-series)	6087928	for pivot elements T63.04, T64, T71, T72 or quick release joint lugs T730, T63.64, T731, T734	3000	25000	add 1280.-

### Accessories

Type	Product No.	Description	-> further accessories see pages 6ff.	Price (€)
TK 501-180x70	6088035	upper suspension w/o pendulum damper for closed jib end (ATLAS) width 345 / Ø80 mm (=TK-Serie) u. DW 15F340-70/integrated DW		1190.-
TK 511-180x70	6078574	upper suspension with pendulum damper for closed jib end (ATLAS) width 345 / Ø80 mm (=TK-Serie) u. DW 15F340-70/integrated DW		2125.-
GA10 MS10 19t	6085653	adapter for quick change system Lehnhoff SW/MS10 without upper suspension- up to 19t		1600.-
GA 20 MS20 26t	6085654	adapter for quick change system Lehnhoff SW/MS20 without upper suspension- up to 26t		2450.-
		adapter for quick change systems from other manufacturers available		on request

### Requirements of excavator

**Operating pressure:** max. 35 MPa (350 bar)  
**Pump capacity:** 75 to 150 l/min

### Technical drawings

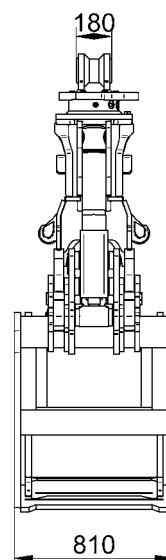
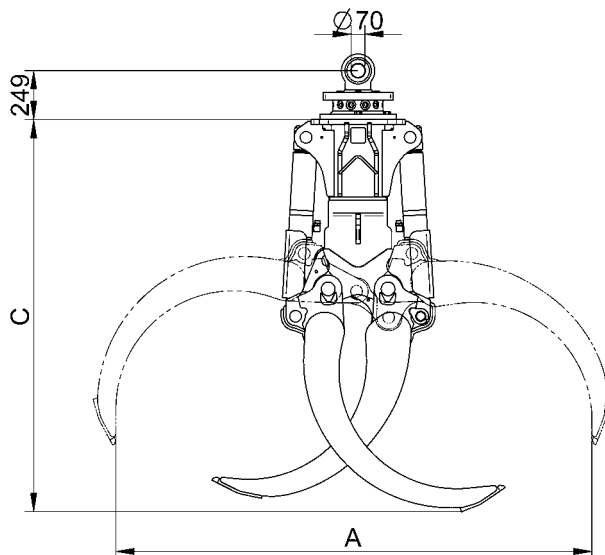

**optional:**  
 special head plate fitting to  
 pivot elements T63.04, T64, T71, T72  
 or quick release joint lug T730, T63.64,  
 T731, T734



**E 724/2V****Timber grapple**

The timber grapple E 724/2V are designed to handle timber - with the same advantages for which all TEREX ATLAS grapples are renowned.

- In addition to the grapple the grab rotation device E 732 is necessary

**Timber grapple E 724/2V**

Price	Type	Product No.	Width B (mm)	Opening range S (mm)	Height Hg (mm)	Capacity (m <sup>3</sup> )	Self weight (kg)	Closing force (kN)	Operating weight excavator (t)
(€) 16100.- T	<b>E 724/2V</b>	<b>6015584</b>	800	2900	2260	1,30	1000	20	20 - 35

Package consists of: Grapple

**Grab rotation device**

Price	Type	Product No.	Torque (Nm)	Additional Height (mm)	Self weight (kg)	Excavator type TEREX ATLAS (t)
(€) 4490.- T	<b>E 732</b>	<b>4515511</b>	2250	420	170	1604/1805/1905 1804 1704/2005/2205

**Please note:** Grab rotation device can only be used in combination with TEREX ATLAS clamshell buckets

**Accessories**

-> further accessories see pages 6ff.

Price	Type	Product No.	Description
(€) 750.- T	<b>T 64</b>	<b>2228779</b>	pivot element for jib end width 268 mm (closed) with pin-Ø 60, length 450 mm
770.- T	<b>T 63.04</b>	<b>4568490</b>	pivot element for jib end width 300 mm (closed) with pin-Ø 80, length 400 mm
940.- T	<b>T 72</b>	<b>1572898</b>	pivot element for jib end width 345 mm (closed) with pin-Ø 80, length 380 mm
1060.- T	<b>T 730</b>	<b>4578174</b>	quick release joint lug for jib end width 268 mm (closed) with pin-Ø 60, length 420mm
1380.- T	<b>T 63.34</b>	<b>4568003</b>	quick release joint lug for jib end width 300 mm (closed) with pin-Ø 80, length 450mm
1380.- T	<b>T 734</b>	<b>3510876</b>	quick release joint lug for jib end width 345 mm (closed) with pin-Ø 80, length 455mm
-			Hose package -> see page "Hose packages for Grapple mit Grab rotation device"

**Requirements of excavator**

**Operating pressure:** max. 30 MPa (300 bar)  
**max. pump capacity:** 250 l/min.

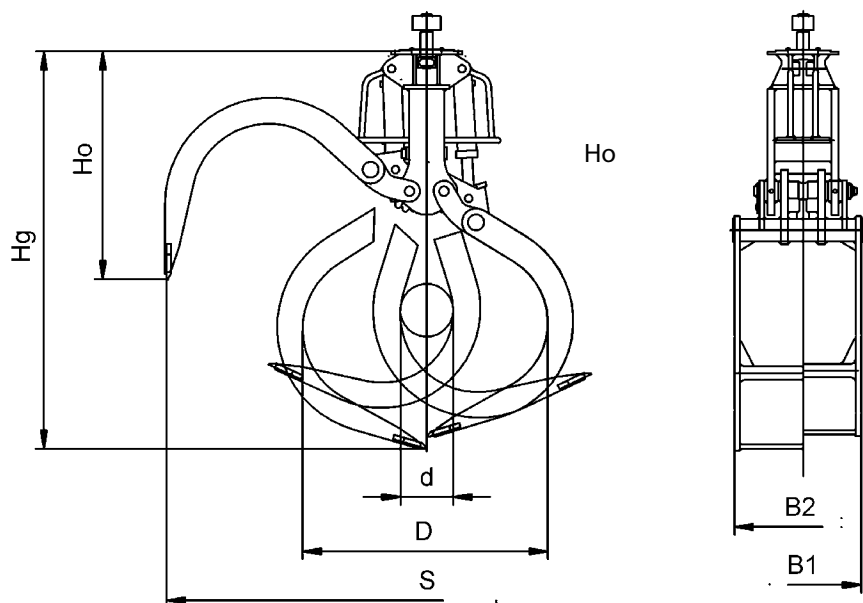
**Technical drawings**

all taxes  
extra

## Beet grapple

## RUEG 25H

Grapple for the handling of beets for excavators up to 25t operating weight. Rounded teeth and the special shell construction make a „smooth“ handling of the beets possible.

- Larger gripping volume makes fast handling possible. The rounded grapple-ribs and teeth reduce breakage of the beets to a minimum. The ribs let pass sand and small stones
- robust, fully integrated rotator that is fixed at 4 points to withstand oncoming forces, with pressure relief valve to ensure overload protection, with connecting hoses located inside the hub
- exceptional closing force (32 kN at an operating pressure of 32 MPa) through two strong hydraulic cylinders



### Beet grapple RUEG 25H

Type	Product No.	Width (mm)	Volume (litre)	Self weight (kg)	Load capacity (kg)	Closing force (kN)	Torque (Nm)	Price (€)
RUEG 25H-200	6086176	2000	2300	1650	4000	32	4000	22255.-

**Package consists of:** Beet grapple, integrated rotator with 4 fixing points (Pin-Ø 70/ Width 180 mm), non-return valve.

### Accessories

-> further accessories see pages 6ff.

Type	Product No.	Description	Price (€)
TK 501 - 180x70	6088035	upper suspension w/o pendulum damper for closed jib end (ATLAS) width 345 / Ø 80 mm & integrated rotator	1190.-
TK 511 - 180x70	6078574	upper suspension with pendulum damper for closed jib end (ATLAS) width 345 / Ø 80 mm & integrated rotator	2125.-
GA10 MS10 18t	6085653	adapter for quick change system for Lehnhoff SW MS10 – up to 19t	1600.-
GA20 MS20 26t	6085654	adapter for quick change system for Lehnhoff SW MS20 – up to 26t	2450.-
		adapter for quick change systems from other manufacturers available	on request

### Requirements of excavator

**Operating pressure:** max. 32 MPa (320 bar)  
**Pump capacity:** 75 to 150 l/min.  
**Hydraulic connection:** rotator: G 1/2"; grapple: SAE 3/4"

### Technical drawings

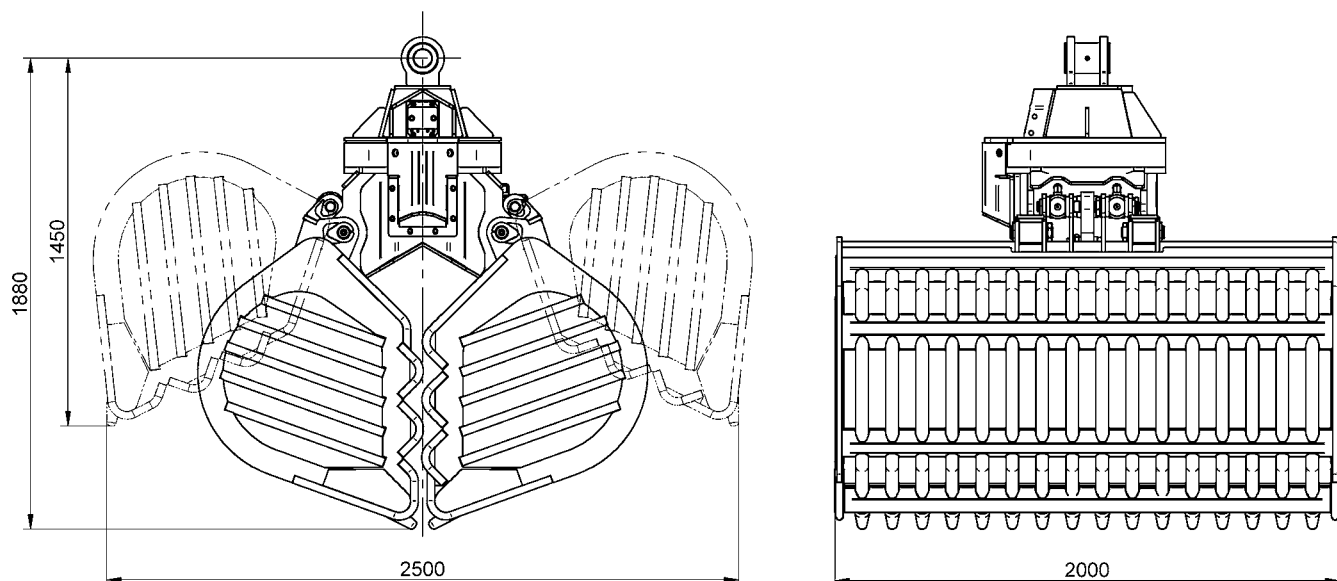

all taxes  
extra

**SOR 15H/ 20H/ 27H****Demolition and Sorting Grapple with metal ribs**

**Robust multi purpose grapple for excavators up to 15t/20t/27t operating weight - ideal for demolition and segmentation of all kinds of building materials. Ideal for separating building debris and similar material.**

- the ribs let fine dust and gravel through. The durable cutting edges can retain different materials, with the edge tips
- long life is ensured due to the use of 500 HB steel in the manufacture of replaceable cutting edges
- robust, fully integrated rotator that is fixed at 4 points to withstand external forces, with pressure relief valve to ensure overload protection, with connecting hoses located inside the hub
- exceptional closing forces through two horizontally positioned hydraulic cylinders that are protected by the bucket carrier
- cylinders are hydraulically cushioned

**Demolition and Sorting Grapple with metal ribs SOR 15H/ SOR 20H/ SOR 27H**

Price (€)	Type	Product- No.	Width B (mm)	Opening range A (mm)	Height C (mm)	Volume (litre)	Self weight (kg)	Loading Capacity (kg)	Closing force (kN)	Torque (Nm)	Operating weight (t)
14995.-	<b>SOR 15H-800</b>	<b>6068377</b>	800	1540	1144	300	585	4000	36	3000	11 – 15
16845.-	<b>SOR 20H-1000</b>	<b>6063406</b>	1000	1885	1353	450	1015	5000	42	4000	14 – 20
20105.-	<b>SOR 27H-1150</b>	<b>6075553</b>	1150	2142	1515	800	1595	6000	63	5000	18 – 27

**Package consists of:** demolition- and sorting grapple, integrated rotator with 4 fixing points, cutting edges and non-return valve

**Accessories**

-> further accessories see page 6ff.

Price (€)	Type	Product No.	Description
1295.-	<b>AFest 15t</b>	<b>6085665</b>	adapter for rigid mounting – up to 15t
1315.-	<b>AFest 20t</b>	<b>6085666</b>	adapter for rigid mounting – up to 20t
1810.-	<b>AFest 27t</b>	<b>6085667</b>	adapter for rigid mounting – up to 27t
1720.-	<b>SA10 MS10 19t</b>	<b>6071057</b>	adapter (SW10) for Lehnhoff quick change system SW/MS10 for rigid mounting – up to 19t
1945.-	<b>SA20 MS20 26t</b>	<b>6085674</b>	adapter (SW20) for Lehnhoff quick change system SW/MS20 for rigid mounting – up to 26t
2165.-	<b>SA21 MS21 28t</b>	<b>6075689</b>	adapter (SW21) for Lehnhoff quick change system SW/MS21 for rigid mounting – up to 28t
on request			adapter for quick exchange systems from other manufacturers available
on request			bolt on side plates
on request			retrofitted plate to close backside for handling of small material

**Requirements of excavator****Operating pressure:****Pump capacity:****Hydraulic connection (rotator/grapple)****SOR 15H/SOR 20H**

max. 32 MPa (320 bar)

75 to 150 l/min.

R 1/2" / SAE 3/4"

**SOR 27H**

max. 35 Mpa (350 bar)

75 to 150 l/min.

R 1/2" / SAE 3/4"

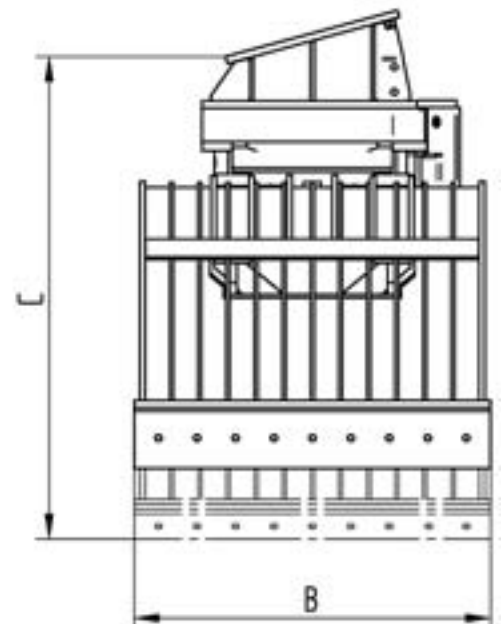
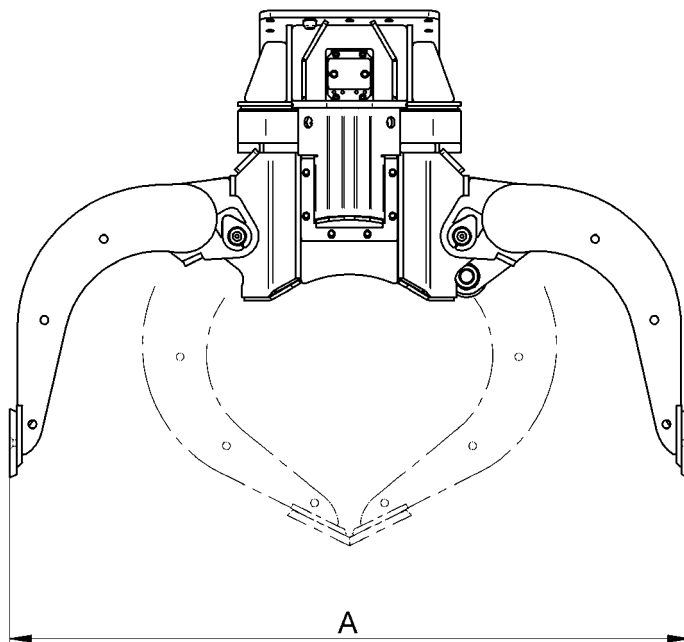
**Technical drawings**

all taxes  
extra

## Demolition and Sorting Grapple with perforated skin

## SOR 15H-P/ 20H-P/ 27H-P

**Robust multi purpose grapple for excavators up to 15t/20t/27t operating weight - ideal for demolition and segmentation of all kinds of building materials. Ideal for seperating building debris and similar material.**

- the shells with the perforated skin let fine dust and gravel through - without big pieces getting tangled up the durable cutting edges can retain different materials, with the edge tips
- long life is ensured due to the use of 500 HB steel in the manufacture of replaceable cutting edges
- robust, fully integrated rotator that is fixed at 4 points to withstand external forces, with pressure relief valve to ensure overload protection, with connecting hoses located inside the hub
- exceptional closing forces through two horizontally positioned hydraulic cylinders that are protected by the bucket carrier
- cylinders are hydraulically cushioned

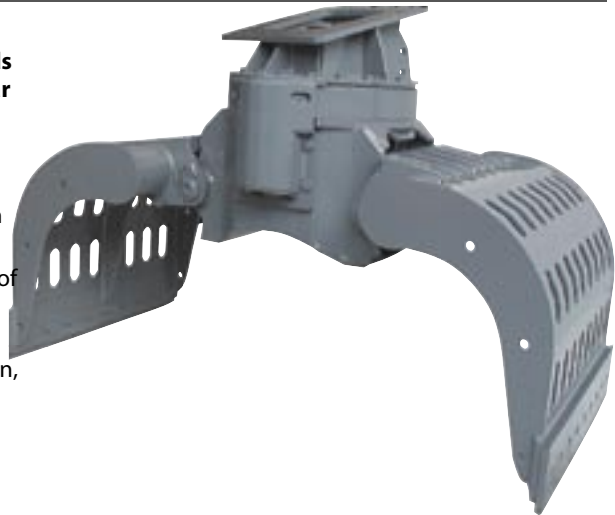

### Demolition and Sorting Grapple with metal ribs SOR 15H-P/ SOR 20H-P/ SOR 27H-P

Type	Product-No.	Width B (mm)	Opening range A (mm)	Height C (mm)	Volume (litre)	Self weight (kg)	Loading Capacity (kg)	Closing force (kN)	Torque (Nm)	Operating weight (t)	Price (€)
SOR 15H-P800	6085960	800	1540	1144	300	580	4000	36	3000	11 – 15	14245.–
SOR 20H-P1000	6085971	1000	1885	1353	450	990	5000	42	4000	14 – 20	16000.–
SOR 27H-P1150	6085972	1150	2142	1515	800	1515	6000	63	5000	18 – 27	19100.–

**Package consists of:** demolition- and sorting grapple, integrated rotator with 4 fixing points, cutting edges and non-return valve

### Accessories

-> further accessories see page 6ff.

Type	Product-No.	Description	Price (€)
AFest 15t	6085665	adapter for rigid mounting – up to 15t	1295.–
AFest 20t	6085666	adapter for rigid mounting – up to 20t	1315.–
AFest 27t	6085667	adapter for rigid mounting – up to 27t	1810.–
SA10 MS10 19t	6071057	adapter (SW10) for Lehnhoff quick change system SW/MS10 for rigid mounting – up to 19t	1720.–
SA20 MS20 26t	6085674	adapter (SW20) for Lehnhoff quick change system SW/MS20 for rigid mounting – up to 26t	1945.–
SA21 MS21 28t	6075689	adapter (SW21) for Lehnhoff quick change system SW/MS21 for rigid mounting – up to 28t	2165.–
		adapter for quick exchange systems from other manufacturers available	on request
		bolt on side plates	
		retrofitted plate to close backside for handling of small material	

### Requirements of excavator

**Operating pressure:**

**Pump capacity:**

**Hydraulic connection (rotator/grapple)**

#### SOR 15H/SOR 20H

max. 32 MPa (320 bar)

75 to 150 l/min.

R 1/2" / SAE 3/4"

#### SOR 27H

max. 35 Mpa (350 bar)

75 to 150 l/min.

R 1/2" / SAE 3/4"

### Technical drawings

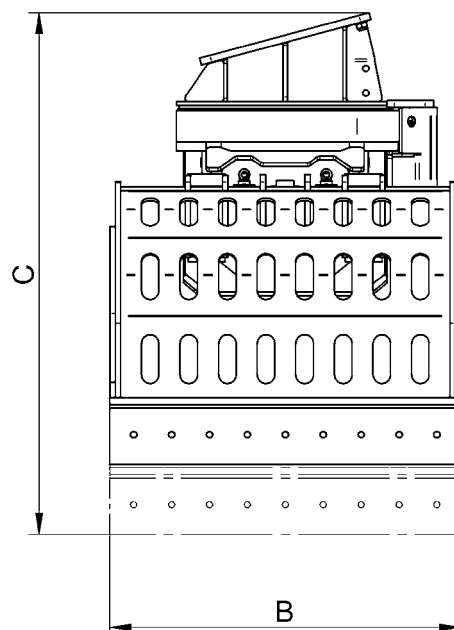
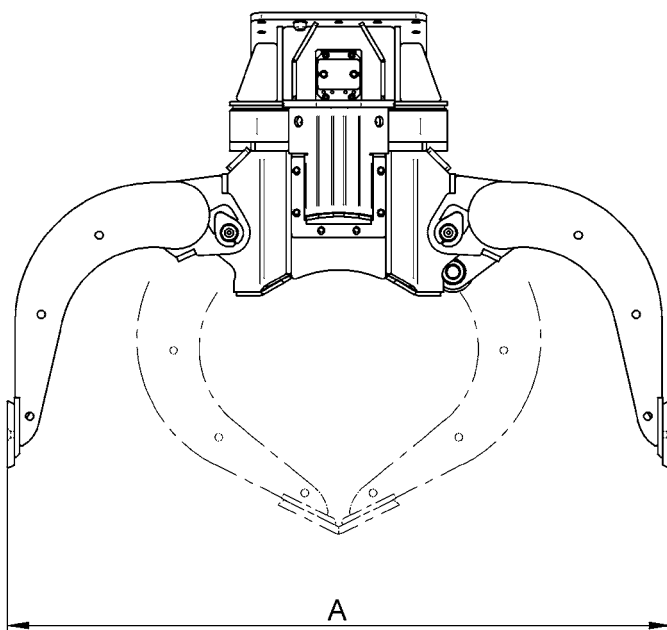

**E 320 - E 321****Orange peel grapple**

**Orange peel grapple for the handling of scrap for excavator from 12 t up to 20 t operating weight.**

- available with 5 tins - in 2 different tine shapes:
  - xx0: open arms
  - xx1: half-open arms
- in addition to the orange peel grapple the grab rotation device E 732 is necessary
- with 5 independently positioned grab rams

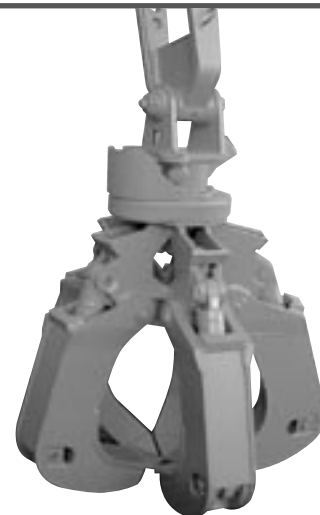
**Orange peel grapple E 320 - E 321**

Price	Type	Product No.	Width B (mm)	Opening range S (mm)	Height Hg (mm)	Volume (litre)	Self weight (kg)	Closing force (kN)	Operating weight excavator (t)
(€)									
16350.- T	<b>E 320</b>	<b>4553835</b>	175	1750	1170	350	925	41	
16600.- T	<b>E 321</b>	<b>5448680</b>	350	1750	1170	350	1000	41	12 - 20

**Package consists of:** Grapple

**Grab rotation device**

Price	Type	Product No.	Torque (Nm)	Additional Height (mm)	Self weight (kg)	Excavator type TEREX ATLAS (t)
(€)						
4490.- T	<b>E 732</b>	<b>4515511</b>	2250	420	170	1204 - 1504/1605 (1604/1705)

**Please note:** Grab rotation device can only be used in combination with TEREX ATLAS clamshell buckets

**Accessories**

-> further accessories see pages 6ff.

Price	Type	Product No.	Description
(€)			
750.- T	<b>T 64</b>	<b>2228779</b>	pivot element for jib end 268 mm (closed) with pin-Ø 60, length 450 mm
1060.- T	<b>T 730</b>	<b>4578174</b>	quick release joint lug for jib end 268 mm (closed) with pin-Ø 60, length 420 mm
-			Hose package -> see page "Hose packages for Grapple mit Grab rotation device"

**Requirements of excavator**

**Operating pressure:** max. 30 MPa (300 bar)  
**max. Pump capacity:** 240 l/min.

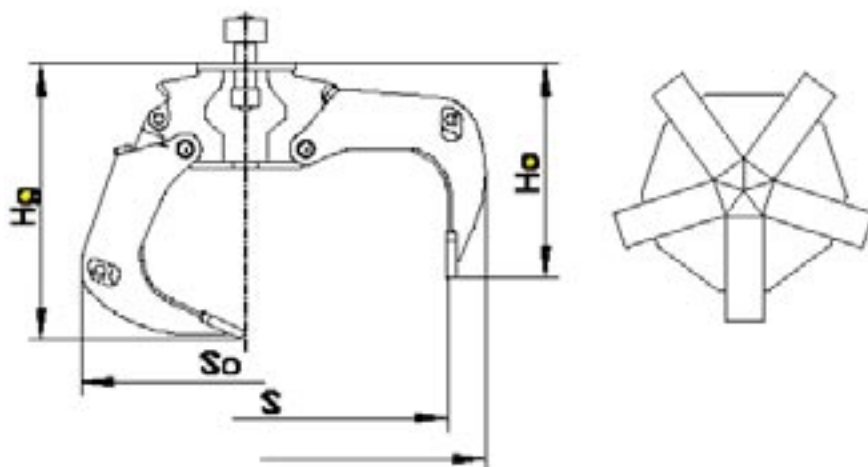
**Technical drawings**



# Orange peel grapple

**MSG 20**

Orange peel grapple for the handling of bulky scrap with excavators from 17t to 20t operating weight

- with 4 or 5 tines available - in 4 different tines shapes
  - F: fully closing tines
  - H: half closing tines
  - W: wide style of pointed tines
  - T: pointed tines
- hydraulic cylinder with protected piston
- oil distribution and hydraulic hoses are protected in the centre section
- tips of tines are exchangeable as spare parts
- closing force 17 kN at an operating pressure of 35 MPa
- optional the grapple can be equipped with a special head plate fitting to pivot elements T63.04, T64, T71, T72 and quick release joint lugs T730, T63.64, T731, T734



## Orange peel grapple MSG 20

Type	Product No.	Width (closed) (mm)	Opening range (mm)	Height (closed) (mm)	Volume (litre)	Number of tines	Self weight (kg)	Load capacity (kg)	Price (€)
MSG 20-450-4-F	6086231	1370	1910	1550	450	4	1045	7000	11210.-
MSG 20-450-4-H	6086232	1370	1910	1550	450	4	910	7000	10860.-
MSG 20-450-4-W	6086234	1370	1910	1550	450	4	850	7000	10680.-
MSG 20-450-4-T	6086233	1370	1910	1550	450	4	810	7000	10550.-
MSG 20-450-5-F	6086235	1370	1910	1550	450	5	1100	7000	12750.-
MSG 20-450-5-H	6083308	1370	1910	1550	450	5	995	7000	12350.-
MSG 20-450-5-W	6086237	1370	1910	1550	450	5	930	7000	12150.-
MSG 20-450-5-T	6086236	1370	1910	1550	450	5	910	7000	12000.-

### Package consists of:

Orange peel grapple, rotator, hose guard and non-return valve

### Rotator

Continuous rotation and two oil passages. Overload protection is ensured by pressure relief valves.

Type	Product No.	Upper connection (WidthxPin-Ø) (mm)	Torque (Nm)	Moment of deflection (Nm)	Price (€)
DW 10F275-60 with standard head plate for TK-suspension		125 x 60	1500	14000	inkl.
optional available with special head plate (incl. pin) for pivot elements (T-series)	6087927	for pivot elements T63.04, T64, T71, T72 or quick release joint lugs T730, T63.64, T731, T734	1500	14000	add 1060.-

### Accessories

-> further accessories see pages 6ff.

Type	Product No.	Description	Price (€)
TK 501 - 125x60	6088029	upper suspension w/o pendulum damper for closed jib end (ATLAS) width 268 / Ø60 mm (=TK-Serie) u. DW 10F275-60	640.-
TK 511 - 125x60	6088048	upper suspension with pendulum damper for closed jib end (ATLAS) width 268 / Ø60 mm (=TK-Serie) u. DW 10F275-60	1300.-
GA 10 MS10 19t	6085653	adapter for quick change system for Lehnhoff SW/MS10 – up to 19t	1600.-
GA 20 MS20 26t	6085654	adapter for quick change system for Lehnhoff SW/MS20 – up to 26t	2450.-
		adapter for quick change systems from other manufacturers available	on request

### Requirements of excavator

#### Operating pressure:

max. 35 MPa (350 bar)

#### Pump capacity:

50 to 150 l/min.

### Technical drawings

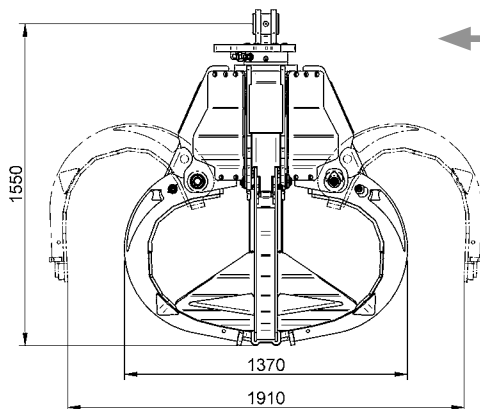

H: Half closing tines



#### optional:

Special head plate fitting to pivot elements T63.04, T64, T71, T72 or quick release joint lug T730, T63.64, T731, T734

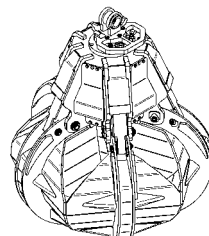

F: Fully closing tines

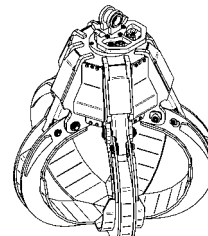

W: wide style of pointed  
tines

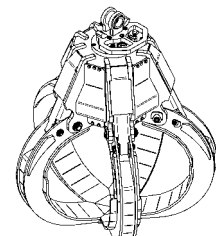

T: Pointed tines

all taxes  
extra

## MSG 25

## Orange peel grapple

**Orange peel grapple for the handling of bulky scrap with excavators from 20t to 25t operating weight**

- with 4 or 5 tines available - in 4 different tines shapes
  - F: fully closing tines
  - H: half closing tines
  - W: wide style of pointed tines
  - T: pointed tines
- hydraulic cylinder with protected piston
- oil distribution and hydraulic hoses are protected in the centre section
- tips of tines are exchangeable as spare parts
- closing force 15 kN at an operating pressure of 35 MPa
- optional the grapple is available with a special head plate fitting to pivot elements T63.04, T64, T71, T72 and the quick release joint lugs T730, T63.64, T731, T734



### Orange peel grapple MSG 25

Price (€)	Type	Product No.	Width (closed) (mm)	Opening range (mm)	Height (closed) (mm)	Volume (litre)	Number of tines	Self weight (kg)	Load capacity (kg)
13995.-	MSG 25-550-4-F	6075307	1460	2180	1680	550	4	1315	7000
13450.-	MSG 25-550-4-H	6078519	1460	2180	1680	550	4	1135	7000
13220.-	MSG 25-550-4-W	6078520	1460	2180	1680	550	4	1040	7000
13085.-	MSG 25-550-4-T	6078531	1460	2180	1680	550	4	995	7000
15400.-	MSG 25-550-5-F	6078532	1460	2180	1680	550	5	1410	7000
14800.-	MSG 25-550-5-H	6078533	1460	2180	1680	550	5	1265	7000
14550.-	MSG 25-550-5-W	6078534	1460	2180	1680	550	5	1200	7000
14400.-	MSG 25-550-5-T	6078535	1460	2180	1680	550	5	1155	7000

Package consists of:

Orange peel grapple, rotator, hose guard and non-return valve

### Rotator

Continuous rotation and two oil passages. Overload protection is ensured by pressure relief valves.

Price (€) inkl.	Type	Product No.	Upper connection (WidthxPin-Ø) (mm)	Torque (Nm)	Moment of deflection (Nm)
add 1060.-	DW 10F275-60 with standard head plate for TK-suspension		125 x 60	1500	14000
	optional available with head plate (incl. pin) for pivot elements (T-series)	6087927	for pivot elements T63.04, T64, T71, T72 or quick release joint lugs T730, T63.64, T731, T734	1500	14000

### Accessories

-> further accessories see pages 6ff.

Price (€) on request	Type	Product No.	Description
640.-	TK 501 - 125x60	6088029	upper suspension w/o pendulum damper for closed jib end (ATLAS) width 268 / Ø60 mm (=TK-Serie) u. DW 10F275-60
1300.-	TK 511 - 125x60	6088048	upper suspension with pendulum damper for closed jib end (ATLAS) width 268 / Ø60 mm (=TK-Serie) u. DW 10F275-60
1600.-	GA 10 MS10 19t	6085653	adapter for quick change system for Lehnhoff SW/MS10 – up to 19t
2450.-	GA 20 MS20 26t	6085654	adapter for quick change system for Lehnhoff SW/MS20 – up to 26t
			adapter for quick change systems from other manufacturers available

### Requirements of excavator

Operating pressure:

max. 35 MPa (350 bar)

Pump capacity:

50 to 150 l/min.

### Technical drawings

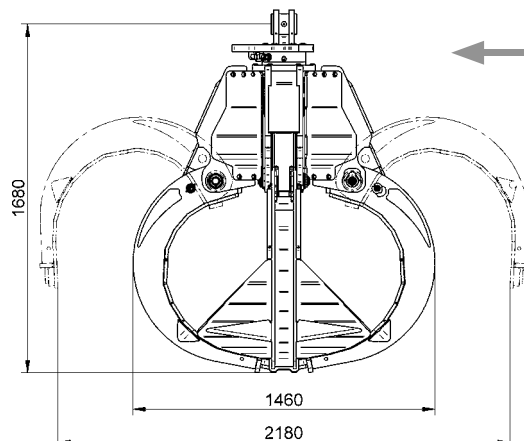

H: Half closing tines



F: Fully closing tines



W: wide style of pointed tines

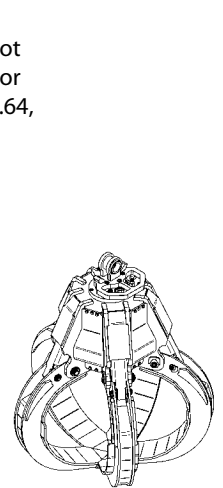

T: Pointed tines

**optional:**  
Special head plate fitting to pivot elements T63.04, T64, T71, T72 or quick release joint lugs T730, T63.64, T731, T734

all taxes  
extra

## Orange peel grapple

**E 650 - E 751**

Orange peel grapple for the handling of scrap for excavator from 17t up to 35t operating weight.

- available with 5 tins - in 2 different tine shapes:
  - xx0: open arms
  - xx1: half-open arms
- in addition to the orange peel grapple the grab rotation device E 732 is necessary
- with 5 independently positioned grab rams



### Orange peel grapple E 650 - E 751

Type	Product No.	Width B (mm)	Opening range S (mm)	Height Hg (mm)	Volume (litre)	Self weight (kg)	Closing force (kN)	Operating weight excavator (t)	Price (€)
E 650	4538154	175	2080	1700	500	1200	30	17 - 35	18900.- T
E 651	4532318	450	2080	1700	500	1350	30		19900.- T
E 750	4533853	175	2175	1750	600	1270	28		19050.- T
E 751	4533842	450	2175	1750	600	1410	28		20600.- T

Package consists of: Grapple

### Grab rotation device

Type	Product No.	Torque (Nm)	Additional Height (mm)	Self weight (kg)	Excavator type TEREX ATLAS (t)	Price (€)
E 732	4515511	2250	420	170	1604/1805/1905 1804 1704/2005/2205	4490.- T

**Please note:** Grab rotation device can only be used in combination with TEREX ATLAS clamshell buckets

### Accessories

-> further accessories see pages 6ff.

Type	Product No.	Description	Price (€)
T 64	2228779	pivot element for jib end width 268 mm (closed) with pin-Ø 60, length 450 mm	750.- T
T 63.04	4568490	pivot element for jib end width 300 mm (closed) with pin-Ø 80, length 400 mm	770.- T
T 72	1572898	pivot element for jib end width 345 mm (closed) with pin-Ø 80, length 380 mm	940.- T
T 730	4578174	quick release joint lug for jib end width 268 mm (closed) with pin-Ø 60, length 420mm	1060.- T
T 63.34	4568003	quick release joint lug for jib end width 300 mm (closed) with pin-Ø 80, length 450mm	1380.- T
T 734	3510876	quick release joint lug for jib end width 345 mm (closed) with pin-Ø 80, length 455mm	1380.- T
Hose package -> see page "Hose packages for Grapple mit Grab rotation device"			-

### Requirements of excavator

Operating pressure: max. 30 MPa (300 bar)  
max. pump capacity: 250 l/min.

### Technical drawings

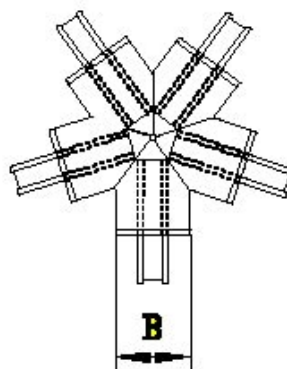
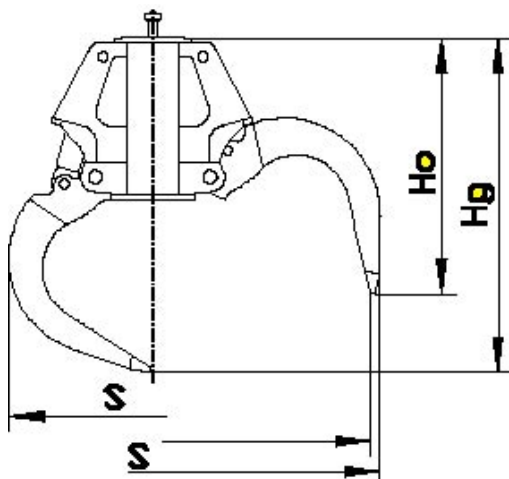

**MSG 35-600-5****Orange Peel Grapple 5-tines with 600 l Volume**

**Orange peel grapple with 5 tines for the handling of bulky scrap with excavators up to 35t operating weight**

- with 5 tines available - in two different tines shapes
  - W: wide style of pointed tines
  - T: pointed tines
- hydraulic cylinder with protected piston
- oil distribution and hydraulic hoses are protected in the centre section
- tips of tines are exchangeable as spare parts
- closing force 38 kN at an operating pressure of 35 MPa
- optional the grapple can be equipped with a special head plate fitting to pivot elements T81, T82 and the quick release joint lug T832

**Orange peel grapple MSG 35-600-5**

Price (€)	Type	Product No.	Width (closed) (mm)	Opening range (mm)	Height (closed) (mm)	Volume (litre)	Number of tines	Self weight (kg)	Load capacity (kg)
18545.-	<b>MSG 35-600-5-W</b>	<b>6086239</b>	1410	2220	1980	600	5	1650	10000
18450.-	<b>MSG 35-600-5-T</b>	<b>6086238</b>	1410	2220	1980	600	5	1600	10000

**Package consists of:** Orange peel grapple, rotator, hose guard and non-return valve

**Rotator**

Continuous rotation and two oil passages. Overload protection is ensured by pressure relief valves.

Price (€) inkl.	Type	Product No.	Upper connection (WidthxPin-Ø) (mm)	Torque (Nm)	Moment of deflection (Nm)
1350.-	<b>DW 15 F340-70</b> with standard head plate for TK-suspension		180 x 70	3000	25000
	<b>optional</b> available with head plate (incl. pin) for pivot elements (T-series)	<b>6087929</b>	for pivot elements T81 and T82 or quick release joint lug T832	3000	25000

**Accessories**

-> further accessories see pages 6ff.

Price (€)	Type	Product No.	Description
1190.-	<b>TK 501 - 180x70</b>	<b>6088035</b>	upper suspension w/o pendulum damper for closed jib end (ATLAS) width 345 / Ø80 mm (=TK-Serie) u. DW 15F340-70/integrated DW
2125.-	<b>TK 511 - 180x70</b>	<b>6078574</b>	upper suspension with pendulum damper for closed jib end (ATLAS) width 345 / Ø80 mm (=TK-Serie) u. DW 15F340-70/integrated DW
2585.- on request	<b>GA25 MS25 40t</b>	<b>6085656</b>	adapter for quick change system for Lehnhoff SW/MS25 – up to 40t adapter for quick change systems from other manufacturers available

**Requirements of excavator**

**Operating pressure:** max. 35 MPa (350 bar)  
**Pump capacity:** 50 to 200 l/min

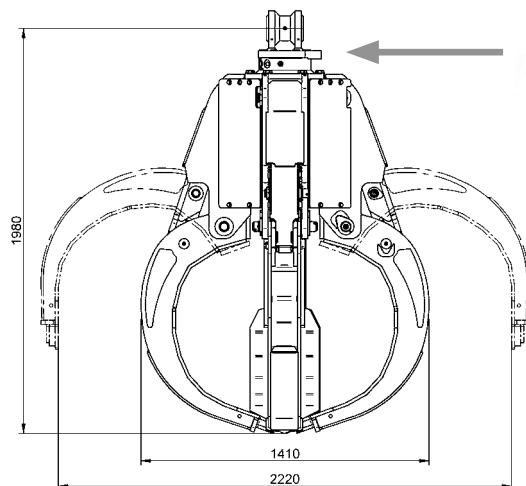
**Technical drawings**

**W: wide style of pointed  
tines**



**optional:**  
Special head plate fitting to pivot  
elements T81, T82 or  
quick release joint lug T832

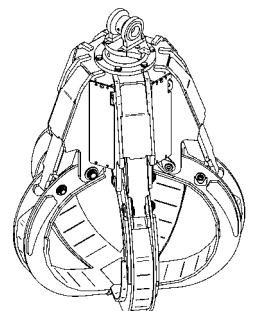

**T: Pointed tines**

all taxes  
extra

## Orange peel grapple

**E 850 - E 861**

**Orange peel grapple for the handling of scrap for excavator from 25 t up to 35 t operating weight**

- available with 5 tins - in 2 different tine shapes:
  - xx0: open arms
  - xx1: half-open arms
- in addition to the orange peel grapple the grab rotation device E 832-2 is necessary
- with 5 independently positioned grab rams



### Orange peel grapple E 850 - E 861

Type	Product No.	Width B (mm)	Opening range S (mm)	Height Hg (mm)	Volume (litre)	Self weight (kg)	Closing force (kN)	Operating weight excavator (t)
E 850	4537380	175	2260	1820	700	1360	31	25 - 35
E 851	4537448	450	2260	1820	700	1540	31	
E 860	4538778	175	2500	1950	900	1420	30	
E 861	4534514	450	2500	1950	900	1640	30	

Package consists of: Grapple

Price  
(€)

22100.- T  
23200.- T  
23350.- T  
24550.- T

### Grab rotation device

Type	Product No.	Torque (Nm)	Additional Height (mm)	Self weight (kg)	Excavator type TEREX ATLAS (t)
E 832-2	6077949	2500	385	180	1804/5205

Price  
(€)

6600.- T

**Please note:** Grab rotation device can only be used in combination with TEREX ATLAS clamshell buckets

### Accessories

-> further accessories see pages 6ff.

Type	Product No.	Description
T 82	3167460	pivot element for jib end width 345 mm (closed) with pin-Ø 80, length 480 mm
T 832	4540738	quick release joint lug for jib end width 345 mm (closed) with pin-Ø 80, length 600 mm
Hose package -> see page "Hose packages for Grapple mit Grab rotation device"		

Price  
(€)

1200.- T  
1530.- T  
-

### Requirements of excavator

**Operating pressure:** max. 30 MPa (300 bar)  
**max. pump capacity:** 350 l/min.

### Technical drawings

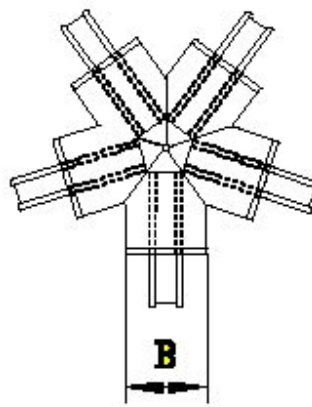
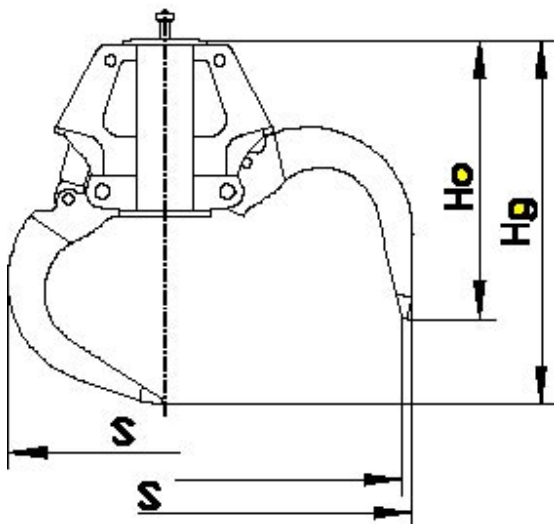



# MSG 35-800-4/-5 Orange Peel Grapple 4- and 5-tines with 800 l Volume

**Orange peel grapple with 4 or 5 tines for the handling of bulky scrap with excavators up to 35t operating weight**

- with 4 tines available - in 2 different tines shapes
  - W: wide style of pointed tines
  - T: pointed tines
- with 5 tines available - in 4 different tines shapes
  - F: fully closing tines
  - H: half closing tines
  - W: wide style of pointed tines
  - T: pointed tines
- hydraulic cylinder with protected piston
- oil distribution and hydraulic hoses are protected in the centre section
- tips of tines are exchangeable as spare parts
- closing force 36 kN at an operating pressure of 35 MPa
- optional the grapple can be equipped with a special head plate fitting to pivot elements T81, T82 and quick release joint lug T832



## Orange peel grapple MSG 35-800-4 and MSG 35-800-5

Price	Type	Product No.	Width (closed) (mm)	Opening range (mm)	Height (closed) (mm)	Volume (litre)	Number of tines	Self weight (kg)	Load capacity (kg)
(€)									
18170.-	MSG 35-800-4-W	6086240	1500	2300	1980	800	4	1460	10000
18060.-	MSG 35-800-4-T	6086241	1500	2300	1980	800	4	1420	10000
19845.-	MSG 35-800-5-F	6086242	1500	2300	1980	800	5	2100	10000
19580.-	MSG 35-800-5-H	6086243	1500	2300	1980	800	5	1850	10000
19470.-	MSG 35-800-5-W	6086244	1500	2300	1980	800	5	1700	10000
19370.-	MSG 35-800-5-T	6086245	1500	2300	1980	800	5	1650	10000

**Package consists of:**

Orange peel grapple, rotator, hose guard and non-return valve

## Rotator

Continuous rotation and two oil passages. Overload protection is ensured by pressure relief valves.

Price	Type	Product No.	Upper connection (Width x Pin-Ø) (mm)	Torque (Nm)	Moment of deflection (Nm)
(€)					
inkl.	DW 15 F340-70 with standard head plate for TK-suspension		180 x 70	3000	25000
1350.-	optional available with head plate (incl. pin) for pivot elements (T-series)	6087929	for pivot elements T81 and T82 or quick release joint lug T832	3000	25000

## Accessories

-> further accessories see pages 6ff.

Price	Type	Product No.	Description
(€)			
1190.-	TK 501 - 180x70	6088035	upper suspension w/o pendulum damper for closed jib end (ATLAS) width 345 / Ø80 mm (=TK-Serie) u. DW 15F340-70/integrated DW
2125.-	TK 511 - 180x70	6078574	upper suspension with pendulum damper for closed jib end (ATLAS) width 345 / Ø80 mm (=TK-Serie) u. DW 15F340-70/integrated DW
2585.-	GA25 MS25 40t	6085656	adapter for quick change system for Lehnhoff SW/MS25 - up to 40t
on request			adapter for quick change systems from other manufacturers available

## Requirements of excavator

**Operating pressure:**

max. 35 MPa (350 bar)

**Pump capacity:**

50 to 200 l/min

## Technical drawings

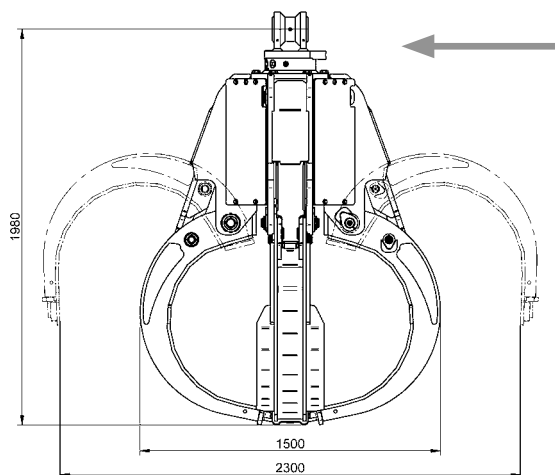

**W: wide style of pointed tines**



**optional:**  
Special head plate fitting to pivot elements T81, T82 or quick release joint lug T832

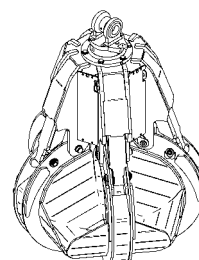

**F: Fully closing tines**

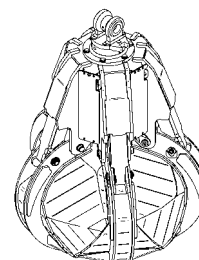

**H: Half closing tines**

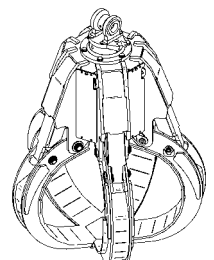

**T: Pointed tines**

all taxes extra

# Orange Peel Grapple with 6 tines

**MSG 35-6**

Orange peel grapple with 6 tines for the handling of bulky scrap with excavators up to 35t operating weight

- the orange peel grapples are available with a volume of 800 and 1000 litres
- with 6 tines - in 4 different tines shapes available
  - F: fully closing tines
  - H: half closing tines
  - W: wide style of pointed tines
  - T: pointed tines
- hydraulic cylinder with protected piston
- oil distribution and hydraulic hoses are protected in the centre section
- closing force 24 kN (P35V-800-6-x) / 22 kN (P35V-1000-6-x) at an operating pressure of 30 MPa
- optional the grapple can be equipped with a special head plate fitting to pivot elements T81, T82 and quick release joint lug T832



## Orange peel grapple MSG 35-6

Type	Product No.	Width B (closed) (mm)	Opening range A (mm)	Height C (closed) (mm)	Height D (open) (mm)	Volume (litre)	Number of tines	Self weight (kg)	Load capacity (kg)	Price (€)
MSG 35-800-6-F	6086247	1480	2250	1820	1525	800	6	1945	7000	20670.-
MSG 35-800-6-H	6086246	1480	2250	1820	1525	800	6	1700	7000	20670.-
MSG 35-800-6-W	6086249	1480	2250	1820	1525	800	6	1555	7000	20670.-
MSG 35-800-6-T	6086248	1480	2250	1820	1525	800	6	1505	7000	20670.-
MSG 35-1000-6-F	6086250	1510	2420	1920	1575	1000	6	2115	8000	27015.-
MSG 35-1000-6-H	6086261	1510	2420	1920	1575	1000	6	1850	8000	27015.-
MSG 35-1000-6-W	6086262	1510	2420	1920	1575	1000	6	1690	8000	27015.-
MSG 35-1000-6-T	6086263	1510	2420	1920	1575	1000	6	1640	8000	27015.-

### Package consists of:

Orange peel grapple, rotator, hose guard and non-return valve

### Rotator

Continuous rotation and two oil passages. Overload protection is ensured by pressure relief valves.

Type	Product No.	Upper connection (WidthxPin-Ø) (mm)	Torque (Nm)	Moment of deflection (Nm)	Price (€)
DW 15 F340-70 with standard head plate for TK-suspension		180 x 70	3000	25000	inkl.
optional available with head plate (incl. pin) for pivot elements (T-series)	6087929	for pivot elements T81 and T82 or quick release joint lug T832	3000	25000	1350.-

### Accessories

-> further accessories see pages 6ff.

Type	Product No.	Description	Price (€)
TK 501 - 180x70	6088035	upper suspension w/o pendulum damper for closed jib end (ATLAS) width 345 / Ø80 mm (=TK-Serie) u. DW 15F340-70/integrated DW	1190.-
TK 511 - 180x70	6078574	upper suspension with pendulum damper for closed jib end (ATLAS) width 345 / Ø80 mm (=TK-Serie) u. DW 15F340-70/integrated DW	2125.-
GA25 MS25 40t	6085656	adapter for quick change system for Lehnhoff SW/MS25 – up to 40t adapter for quick change systems from other manufacturers available	2585.- on request

### Requirements of excavator

Operating pressure: max. 35 MPa (350 bar)  
Pump capacity: 50 to 200 l/min

### Technical drawings

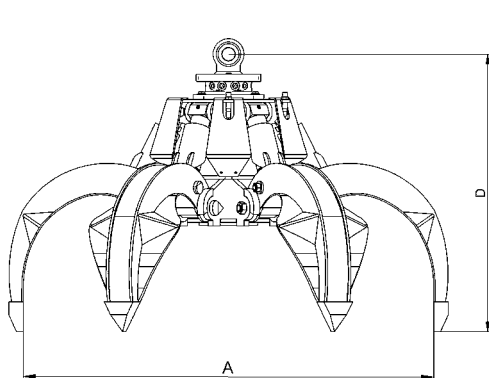

H: Half closing tines

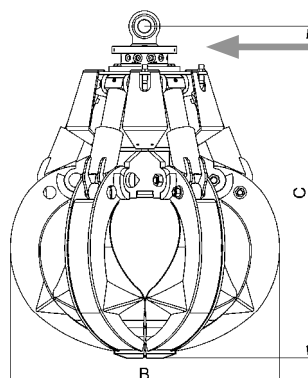

**optional:**  
Special head plate fitting to pivot  
elements T81, T82 or  
quick release joint lug T832

## MSG 50

## Orange peel grapple

**Orange peel grapple for the handling of bulky scrap excavators up to 50t operating weight**

- with 4 tines available - in 2 different tines styles
  - W: wide style of pointed tines
  - T: pointed tines
- with 5 tines available - in 4 different tines styles of the forms
  - F: fully closing tines
  - H: half closing tines
  - W: wide style of pointed tines
  - T: pointed tines
- hydraulic cylinder with protected piston
- oil distribution and hydraulic hoses are protected in the centre section
- tips of tines are exchangeable as spare parts
- closing force 33 kN at an operating pressure of 35 MPa
- optional the grapple can be equipped with a special head plate fitting to pivot elements T81, T82 and quick release joint lug T832



### Orange peel grapple MSG 50

Price	Type	Product No.	Width (closed) (mm)	Opening range (mm)	Height (closed) (mm)	Volume (litre)	Number of tines	Self weight (kg)	Load capacity (kg)
(€)									
19955.-	MSG 50-1000-4-W	6078547	1590	2500	2110	1000	4	1640	10000
19800.-	MSG 50-1000-4-T	6078548	1590	2500	2110	1000	4	1585	10000
23950.-	MSG 50-1000-5-F	6078549	1590	2500	2110	1000	5	2400	10000
23650.-	MSG 50-1000-5-H	6078550	1590	2500	2110	1000	5	2100	10000
23445.-	MSG 50-1000-5-W	6078571	1590	2500	2110	1000	5	1920	10000
23260.-	MSG 50-1000-5-T	6078572	1590	2500	2110	1000	5	1850	10000

### Package consists of:

Orange peel grapple, rotator, hose guard and non-return valve

### Rotator

Continuous rotation and two oil passages. Overload protection is ensured by pressure relief valves.

Price	Type	Product No.	Upper connection (WidthxPin-Ø) (mm)	Torque (Nm)	Moment of deflection (Nm)
(€)					
inkl.	DW 15 F340-70 with standard head plate for TK-suspension		180 x 70	3000	25000
1350.-	optional available with head plate (incl. pin) for pivot elements (T-series)	6087929	for pivot elements T81 and T82 or quick release joint lug T832	3000	25000

### Accessories

-> further accessories see pages 6ff.

Price	Type	Description
(€)		
1150.-	TK 501 - 180x70	6088035 upper suspension w/o pendulum damper for closed jib end (ATLAS) width 345 / Ø80 mm (=TK-Serie) u. DW 15F340-70/integrated DW
2050.-	TK 511 - 180x70	6078574 upper suspension with pendulum damper for closed jib end (ATLAS) width 345 / Ø80 mm (=TK-Serie) u. DW 15F340-70/integrated DW
2585.-	GA25 MS25 40t	6085656 adapter for quick change system for Lehnhoff SW/MS25 - up to 40t
6300.-	GA40 HS40 70t	6085657 adapter for quick change system for Lehnhoff SW/HS40 - up to 70t
on request		adapter for quick change systems from other manufacturers available

### Requirements of excavator

**Operating pressure:** max. 35 MPa (350 bar)  
**Pump capacity:** 50 to 200 l/min

### Technical drawings

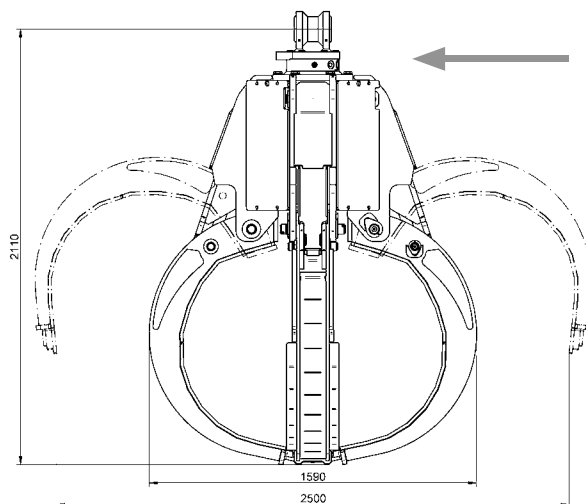

**W: wide style of pointed tines**



**optional:**  
Special head plate fitting to pivot elements T81, T82 or quick release joint lug T832

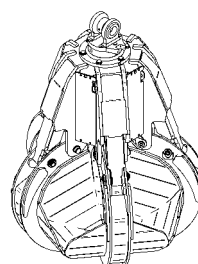

**F: Fully closing tines**

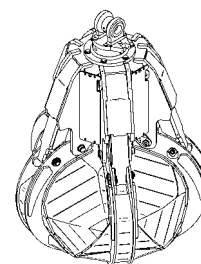

**H: Half closing tines**

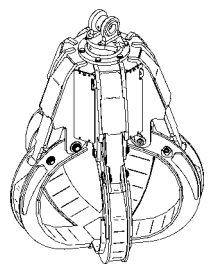

**T: Pointed tines**

all taxes extra

## USPs of the orange peel grapple type MSG

### Safety:



- all hoses are inside the grab frame and fully protected
- hydraulic cylinders are fully enclosed and protected from damage
- pilot controlled check valve as standard to prevent grapple from unintentionally opening due to leakage or hose failure
- check valve ensures material is retained safely inside the tines of the grapple

### Robust design:

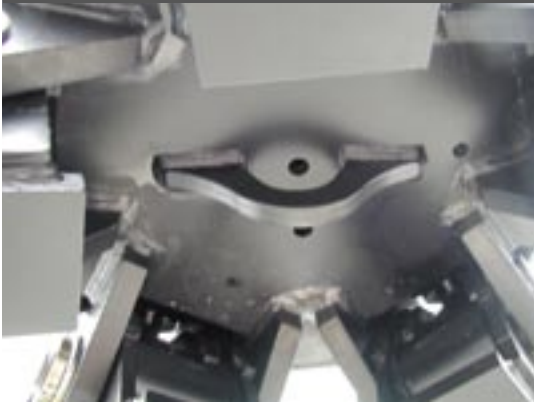

- structure is made of high strength fine grained steel, liners are made of Hardox 400
- tine tips are made of Hardox 500 and easily replaceable (quick change system)
- hardened pins, retained by castellated nuts

### Efficiency:



- high clamping force due to optimized kinematics
- high working speed due to optimally sized hydraulic cylinders
- high pressure hydraulics (up to 350bar)
- weight optimized design – all structural components have been calculated and optimized with FEM (Finite Element Method)

### Tine construction:

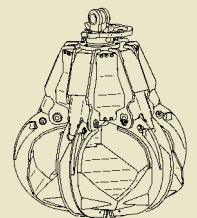

- massive tine stops relieve hydraulic cylinders from shock loads
- self cleaning construction of the tines avoids damage of the hydraulic cylinder
- grapples are available with 4, 5 or 6 tines in 4-different profiles
- lifting eye underneath the carrier comes as standard (magnet shackle)

**Attachments for Excavators 15 t - 60 t | Industrial Solutions**

**ATLAS-TEREX GmbH**  
**Atlasstr. 6**  
**27777 Ganderkesee**  
**Germany**  
**Tel. +49 (0) 42 22 9 54-0**  
**Fax +49 (0) 42 22 9 54-343**  
**info@atlas-terex.de**  
**www.atlas-terex.de**